

| ELEVATED PLAY ACTIVITIES - TOTAL | RECD |
|-------------------------------------------------|------|
| 13 | 7 |
| ELEVATED PLAY ACTIVITIES ACCESSIBLE BY TRANSFER | 0 |
| ELEVATED PLAY ACTIVITIES ACCESSIBLE BY RAMP | 0 |
| GROUND LEVEL ACTIVITY TYPE | 3 |
| GROUND LEVEL ACTIVITY QUANTITY | 4 |

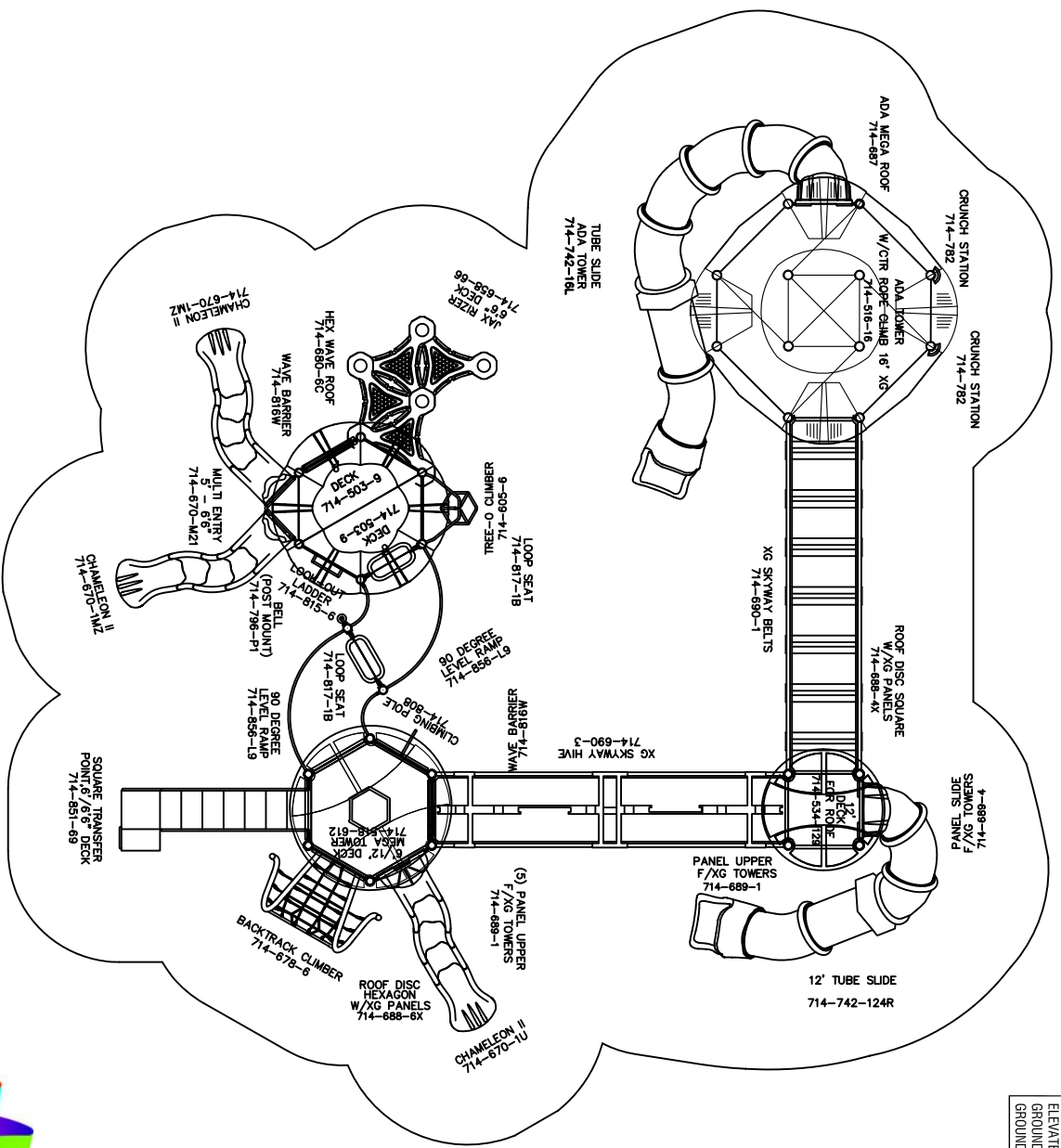

Play Area Capacity: 175-185



To promote safe and proper equipment use by children, Miracle recommends the installation of either a Miracle safety sign or other appropriate safety signage near each play system's main entry point(s) to inform parents and supervisors of the age appropriateness of the play system and general rules for safe play.

THE PLAY COMPONENTS IDENTIFIED IN THIS PLAN ARE IPEMA CERTIFIED. THE USE AND LAYOUT OF THESE COMPONENTS CONFORM TO THE REQUIREMENTS OF ASTM F1487.

AN ENERGY ABSORBING PROTECTIVE SURFACE IS REQUIRED UNDER & AROUND ALL PLAY SYSTEMS.

| | | | | | | |
|-----------------------------------|-----------|------------------|---|------------------|---------------------------------------------------------------------|--------------------|
| GROUND SPACE: PROTECTIVE AREA: | 52' X 48' | 64' X 60' | ✓ | COMPLIES TO ADA | DESIGNED FOR AGES 5-12 | SCALE: 1" = 10'-0" |
| | XG221088 | COMPLIES TO CPSC | ✓ | COMPLIES TO ASTM | | |
| | | | ✓ | COMPLIES TO ADA | ADDITIONAL GROUND LEVEL ACCESSIBLE ITEMS NEEDED FOR ADA COMPLIANCE: | DATE: 7/9/2019 |
| | | | | | TYPE: 0 | QUANTITY: 0 |
| | | | | | | CINDI |

