

General Notes:

Age Group

☒ 2-5yrs ☐ 5-12 yrs ☐ 12-17yrs ☐ 18+ yrs

- 1.The Americans with Disabilities Act (ADA) may require that you make your park and/or playground accessible when viewed in its entirety. Please consult your legal counsel to determine if the ADA applies to you.
- 2.For playground equipment to be considered accessible, accessible surfacing must be utilized in applicable areas.
- 3.Although a particular playground design may not meet the proposed Access Board Regulations in regards to the appropriate number of ground level events, the actual playground may be in compliance when considering existing play components.
- 4.All deck heights are measured from top of ground cover.
- 5.Fall absorbing ground cover is required under and around all play equipment.
- 6.The minimum recommended fall zone around the entire playstructure is shown. This zone is to be free of all tripping or collision hazards (i.e. roots, rocks, border material, etc.).
- 7.All post lengths are identified by text showing the post lengths, i.e. 96 represents a 96 inch post.
- 8.Not all equipment may be appropriate for all children. Supervision is required.

AGE GROUP: 2-5  
ELEVATED PLAY ACTIVITIES - TOTAL: 8  
ELEVATED PLAY ACTIVITIES ACCESSIBLE BY TRANSFER: 8 REQ'D 4  
ELEVATED PLAY ACTIVITIES ACCESSIBLE BY RAMP: 0 REQ'D 0  
GROUND LEVEL ACTIVITY TYPE: 4 REQ'D 3  
GROUND LEVEL QUANTITY: 4 REQ'D 3



CAPACITY - 34  
WEIGHT - 5274  
VOLUME -  
ELEVATED EVENTS - 8  
GROUND LEVEL - 4

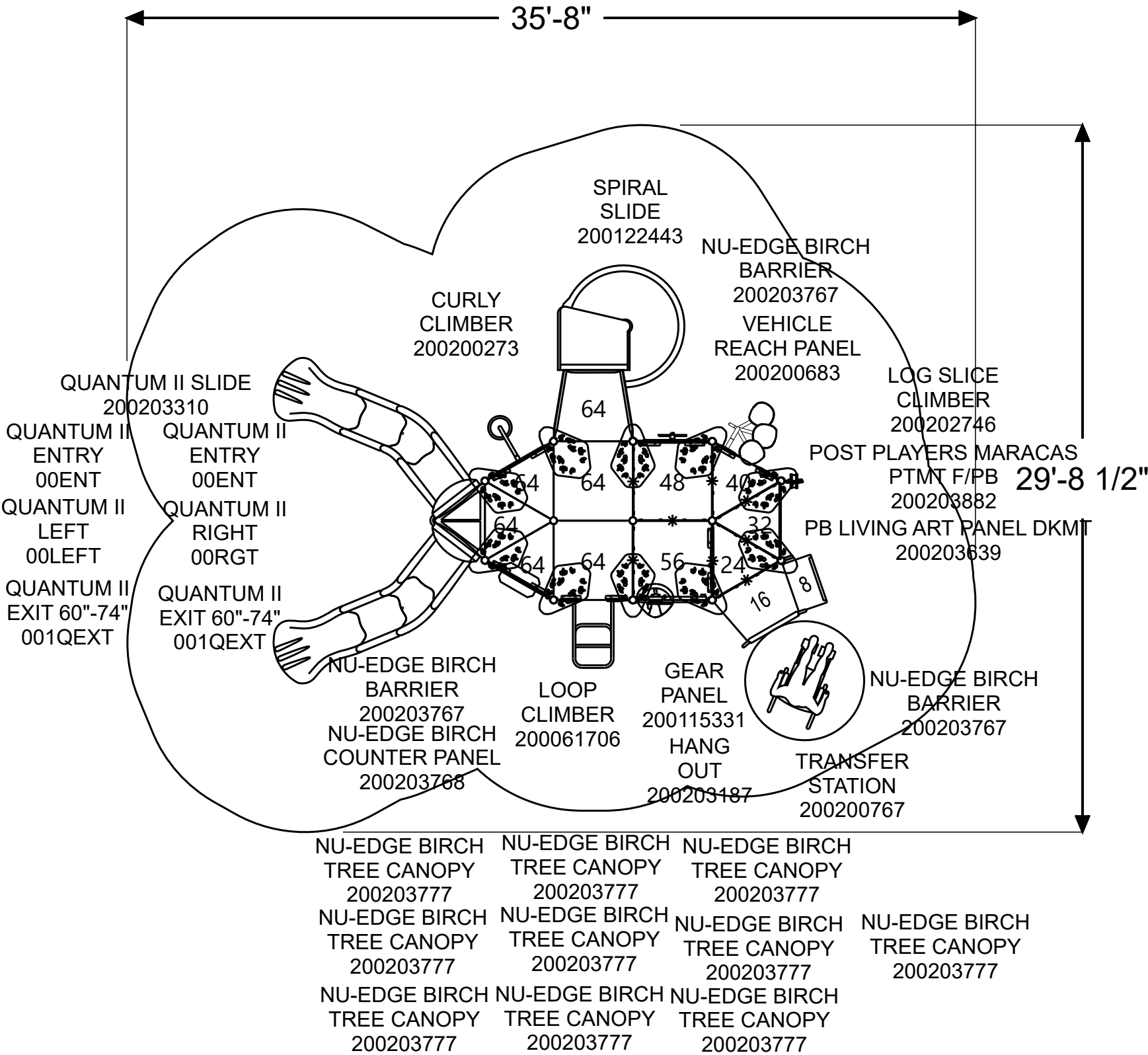

Project:  
PB24-74042  
, MO  
LTCPS rep:  
Donna Friedman  
PPLT  
573-915-7740  
  
Ground Space: 26'-6\"/>

Playground Layout  
Compliance:

- ☒ ASTM F1487 - Playground  
Equipment for Public Use.  
☒ CPSC Handbook for Public  
Playground Safety

- ☒ This playground design meets the  
final Access Board Regulations.



The play components identified in this  
plan are IPEMA certified. The use and  
layout of these components conform to  
the requirements of ASTM F1487.

LEED points for  
this structure  
1

