

| ELEVATED PLAY ACTIVITIES - TOTAL | 28 |
|---|-----------|
| ELEVATED PLAY ACTIVITIES ACCESSIBLE BY TRANSFER | 16 REOD 0 |
| ELEVATED PLAY ACTIVITIES ACCESSIBLE BY RAMPS | 14 REOD 0 |
| GROUND LEVEL ACTIVITY TYPE | 4 REOD 0 |
| GROUND LEVEL ACTIVITY QUANTITY | 7 REOD 0 |

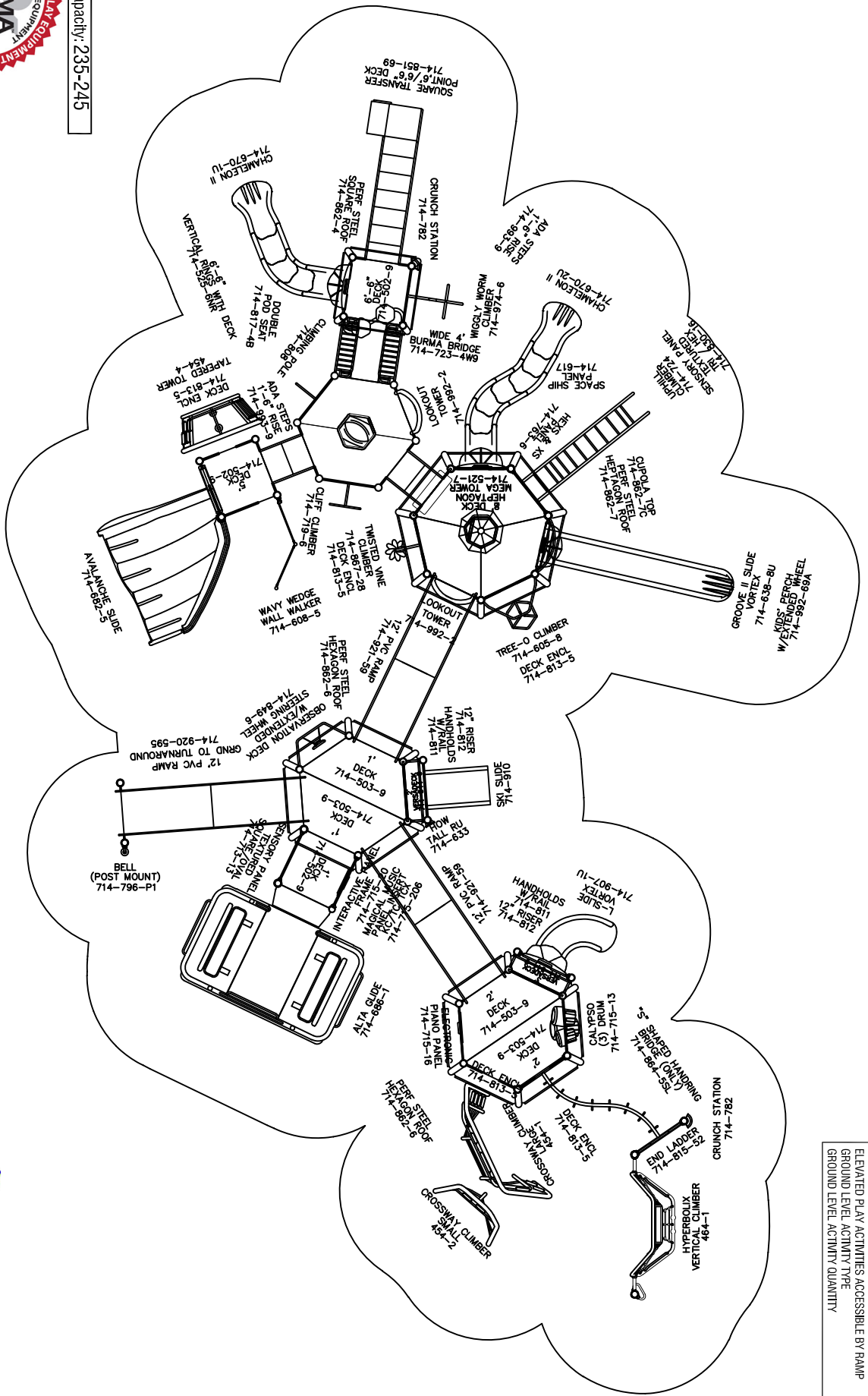

Play Area Capacity: 235-245



To verify product certification, visit www.ipema.org

To promote safe and proper equipment use by children, Miracle recommends the installation of either a Miracle safety sign or other appropriate safety signage near each playsystem's main entry point(s) to inform parents and supervisors of the age appropriateness of the playsystem and general rules for safe play.

THE PLAY COMPONENTS IDENTIFIED IN THIS PLAN ARE IPEMA CERTIFIED. THE USE AND LAYOUT OF THESE COMPONENTS CONFORM TO THE REQUIREMENTS OF ASTM F1487.

AN ENERGY ABSORBING PROTECTIVE SURFACE IS REQUIRED UNDER & AROUND ALL PLAY SYSTEMS.

| | | | | | |
|----------------------------|----------|---|------------------|---|--------------------|
| GROUND SPACE: 81' X 43' | 714-S679 | ✓ | COMPLIES TO CPSC | DESIGNED FOR AGES 5-12 | SCALE: 1" = 10'-0" |
| PROTECTIVE AREA: 93' X 58' | | ✓ | COMPLIES TO ASTM | ADDITIONAL GROUND LEVEL ACCESSIBLE ITEMS NEEDED FOR ADA COMPLIANCE: | DATE: 12/2/2024 |
| | | ✓ | COMPLIES TO ADA | TYPE: 0 | QUANTITY: 0 |

| | |
|---------|-------------|
| | |
| TYPE: 0 | QUANTITY: 0 |
| CINDI | |