

ELEVATED PLAY ACTIVITIES - TOTAL	RECD
28	0
ELEVATED PLAY ACTIVITIES ACCESSIBLE BY TRANSFER	10
ELEVATED PLAY ACTIVITIES ACCESSIBLE BY RAMP	14
ELEVATED PLAY ACTIVITIES ACCESSIBLE BY RAMP	4
GROUND LEVEL ACTIVITY TYPE	7
GROUND LEVEL ACTIVITY QUANTITY	0
	0

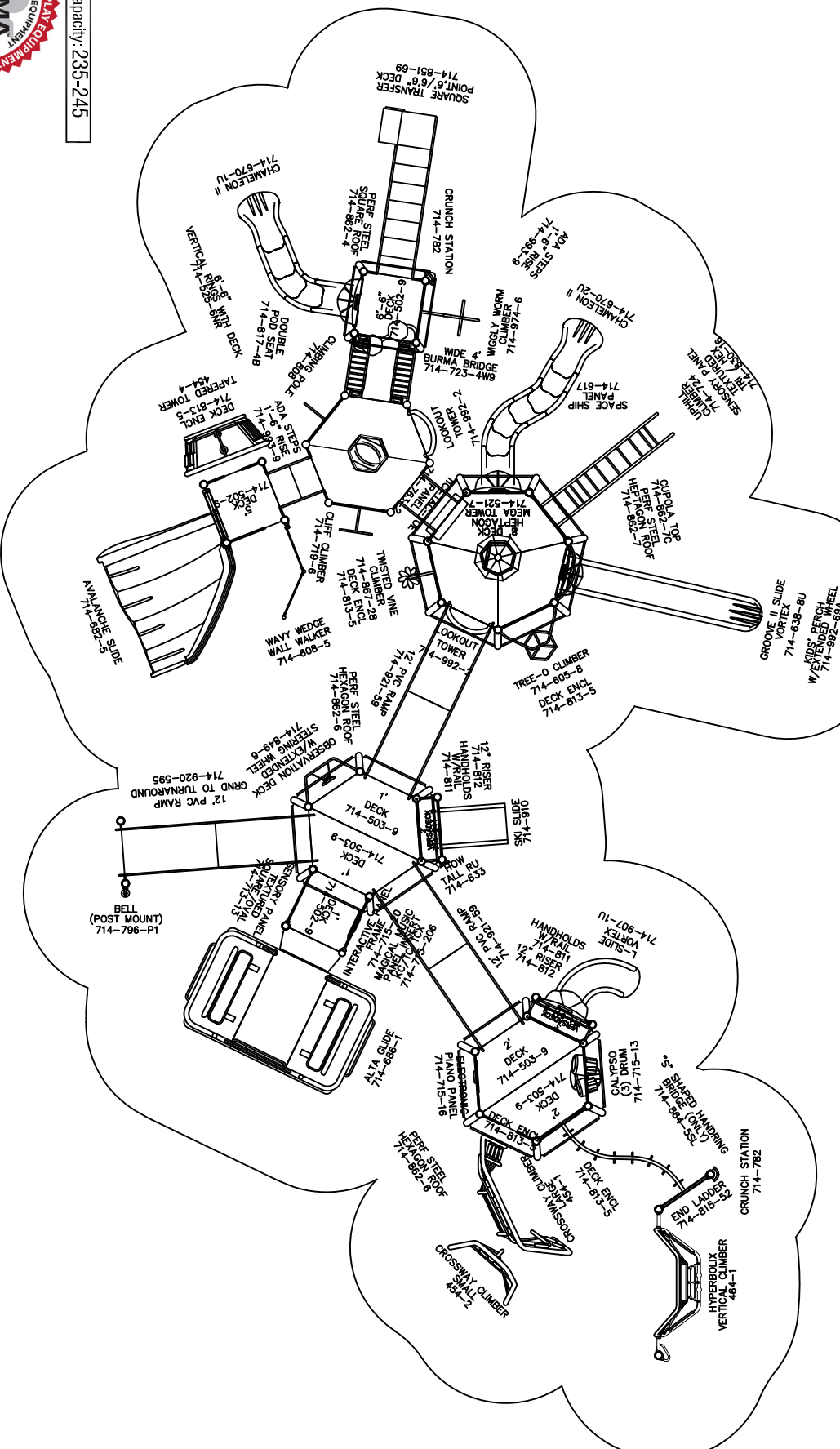

Play Area Capacity: 235-245



To verify identification, visit www.ipema.org

To promote safe and proper equipment use by children, Miracle recommends the installation of either a Miracle safety sign or other appropriate safety signage near each play system's main entry point(s) to inform parents and supervisors of the age appropriateness of the play system and general rules for safe play.

THE PLAY COMPONENTS IDENTIFIED IN THIS PLAN ARE IPEMA CERTIFIED. THE USE AND LAYOUT OF THESE COMPONENTS CONFORM TO THE REQUIREMENTS OF ASTM F1487.

AN ENERGY ABSORBING PROTECTIVE SURFACE IS REQUIRED UNDER & AROUND ALL PLAY SYSTEMS.

714-S679	COMPLIES TO CPSC	DESIGNED FOR AGES 5-12	SCALE: 1" = 10'-0"
GROUND SPACE: 81' X 43'	COMPLIES TO ASTM	ADDITIONAL GROUND LEVEL ACCESSIBLE TYPES NEEDED FOR ADA COMPLIANCE:	DATE: 7/28/2022
PROTECTIVE AREA: 93' X 58'	COMPLIES TO ADA	TYPE: 0	QUANTITY: 0
			CINDI

